

Easy-Buck™ Installation Aluminum Panel Forms

(Always Use Job Specific Personal Protective Equipment)

A. Tool List (Suggested)

1. 4' level

B. Materials List

1. Four (4) standard wall ties

C. Installation Procedure

1. Properly brace Easy-Buck™ before proceeding
 1. See 'Easy-Buck™ Wood Bracing' Tech Data Sheet
2. Layout the Easy-Buck™ location on the outside panels. See 'Easy-Buck™ Aluminum Panels Tie Selection Chart' Tech Data Sheet for additional information.
 1. Ensure that the bottom of the Easy-Buck™ is not greater than 38" from the top of finished floor.
 2. Inside finished sill height may not exceed 44" from top of finished floor. See IRC-2006 R310.1 for additional information.
3. Once Easy-Buck™ location has been determined, place it against the outside wall panels, matching the top wall tie with the top wall tie slot in the jamb. Insert wall tie from exterior side of outside panel thru tie slot of jamb, securing with hardware. Repeat for lower wall tie 24" below.
 1. Ensure that the mounting screws are facing towards the exterior side of the foundation.
4. Set and secure inside form panel, matching the two (2) wall ties.
5. Prior to setting opposite side of Easy-Buck™, ensure that any reinforcement around the Easy-Buck™ is not in direct contact, maintaining a minimum concrete cover of 2".
 1. See ACI 332-08 Standard, 'Requirements for Residential Concrete Construction and Commentary', for additional information.
6. Repeat Steps 3 & 4 for opposite side of Easy-Buck™.
 1. Check for level, plumb, and square before setting last form panel.

Warning: Ensure that no rebar comes in contact with the Easy-Buck. All rebar should be held at least 2" from any surface of the Easy-Buck. A metallic path between the Easy-Buck and Easy-Well can result from rebar touching the Easy-Buck and premature corrosion of the Easy-Well can occur. Failure to ensure no rebar touches the Easy-Buck will void all warranties.

Notes:

1. Easy-Buck™ form panel requirements.
 - a. 4 Foot Easy-Bucks™ equals 54", or 36" full panel and 18" filler panel
 - b. 5 Foot Easy-Bucks™ equals 66", or 36" full panel and 30" filler panel
 - c. 6 Foot Easy-Bucks™ equals 78", or two (2) 36" full panels and 6" filler panel

Easy-Buck™ Installation Wood Panel Forms

(Always Use Suitable Personal Protective Equipment)

A. Tool List (Suggested)

1. 4' level
2. 16 ounce framing hammer

B. Materials List

1. Twenty four (24) 16d x 2" nails

C. Installation Procedure

1. Properly brace Easy-Buck™ before proceeding
 - a. See 'Easy-Buck™ Wood Bracing' Tech Data Sheet
2. Layout the Easy-Buck™ location on the outside panels, checking for any wall tie interference.
 - a. Ensure that the bottom of the Easy-Buck™ is not greater than 38" from the top of finished floor.
 - b. Inside finished sill height may not exceed 44" from top of finished floor. See IRC-2006 R310.1 for additional information.
3. Once Easy-Buck™ location has been determined, proceed by nailing top left, exterior side corner from inside the foundation using the pre-punched hole. Pivot Easy-Buck™ to level position and nail top right, exterior side corner from inside the foundation using the pre-punched hole.
 - a. Ensure that the mounting screws are facing towards the exterior side of the foundation.
 - b. Check for level, plumb, and square.
 - c. Complete nailing the remaining ten (10) holes in the same manner.
4. Prior to setting inside form panels, ensure that any reinforcement around the Easy-Buck™ is not in direct contact, maintaining a minimum concrete cover of 2".
 - a. See ACI 332-08 Standard, 'Requirements for Residential Concrete Construction and Commentary', for additional information.
5. Set and secure inside wall panels.
6. Secure interior side of Easy-Buck™.
 - a. Nail through the inside forms into the interior side of the Easy-Buck™ twelve (12) times @ the pre-punched hole locations.



BASEMENT WINDOW SYSTEMS

Wood Form Section

Welcome to the Wood Form Install Section

Once one side of wood form is installed, locate area for window.



ALERT: BUCK SHOULD BE BRACED WITH 2X4 BEFORE INSTALLATION.

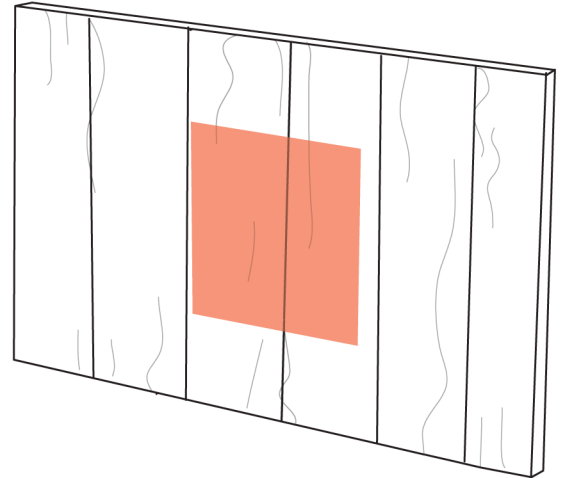

With buck screws facing out, attach one corner of buck to wood form making sure the bottom of the buck is no more than 40" from the floor for Egress. See Egress Section for complete IRC 2000 code.

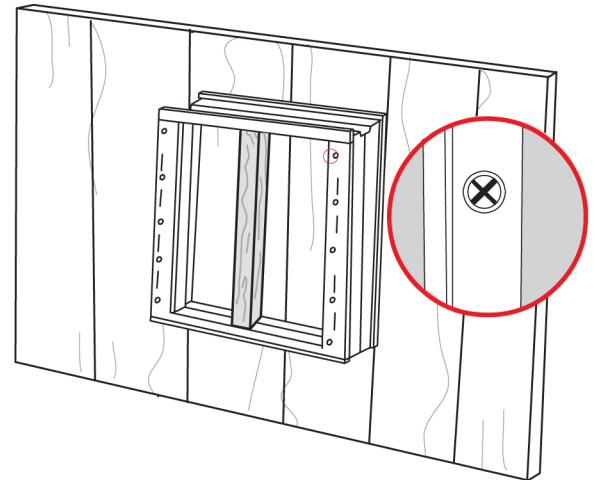

With one corner attached to the wood form, use that area to pivot the Easybuck™ frame until it is level.

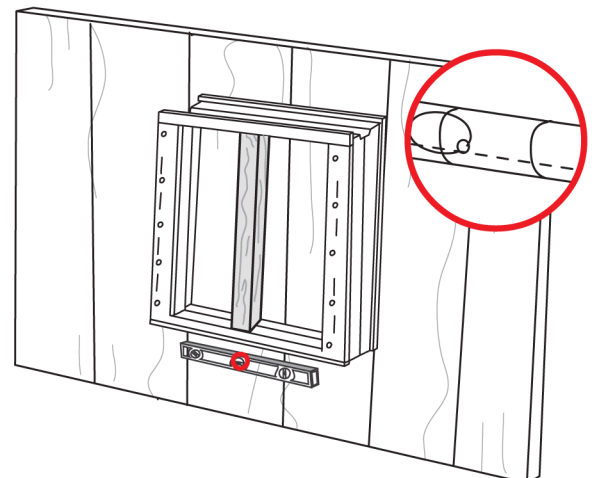

Basement Egress Windows Made Easy!

www.boman-kemp.com

Pound 1st nail on top of buck.

Check level again before setting 2nd nail on top.

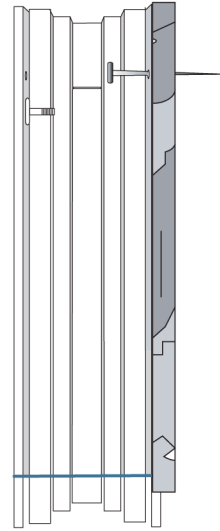

Once you are level, drive remaining nails – three on each side. Upon attachment, make one final check for squareness by cross measuring the frame.

Next, nail inside.

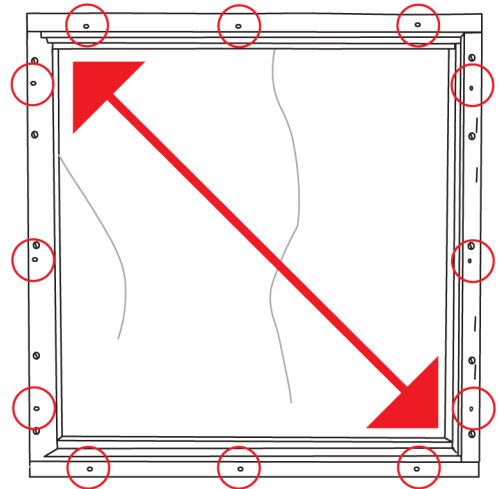

Once the second wood form is in place, locate buck in wall and nail thru from outside of wood form.

EasyBucks™ are able to withstand normal installation functions such as pouring, pumping, and vibrating.

You are now ready to move onto the Well Install Section.

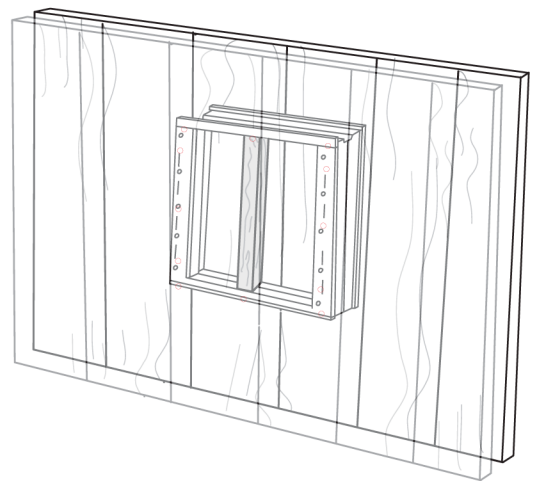



BASEMENT WINDOW SYSTEMS

Aluminum Form Section

Welcome to the Aluminum Form Install Section

Once aluminum forms are in place, locate where window is to be placed. Insert braced EasyBuck™.



ALERT: BUCK SHOULD BE BRACED WITH 2X4 BEFORE INSTALLATION

While inserting window buck into wall, make sure that the buck nuts are facing out and that the bottom of the buck is no more than 40" from floor for Egress. See Egress Section for complete IRC 2000 code.

Once tie slots are found on buck, insert tie thru aluminum form and thru buck tie slot to other side of form.

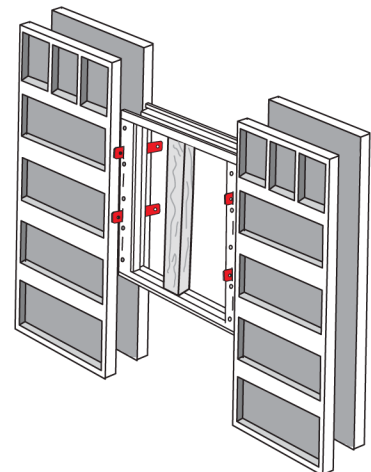
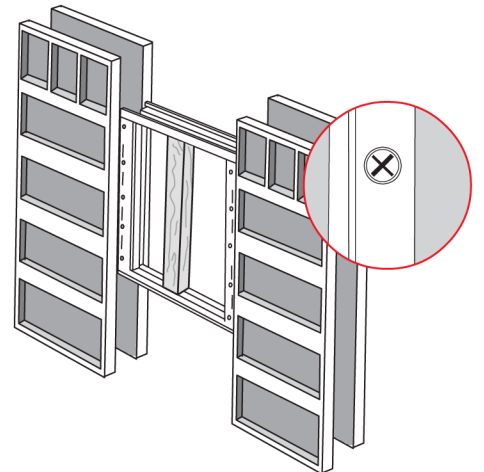
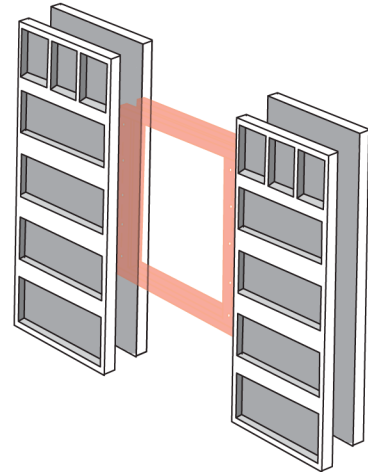

Pin and secure tie.

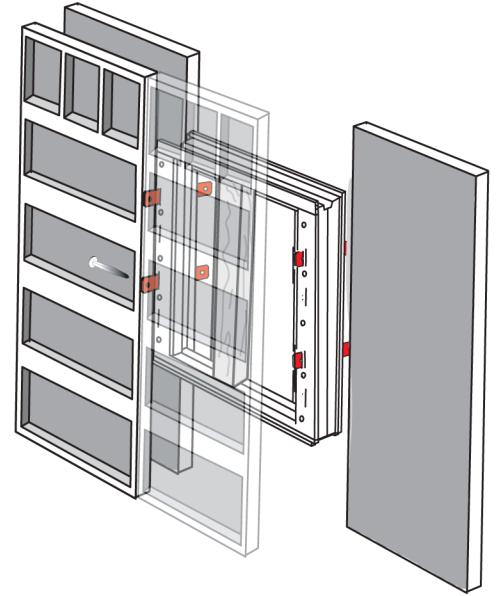

NOTE: STANDARD BOMAN KEMP 4040 WINDOW
REQUIRES A 36" AND 18" FILLER PANEL.

The window is now ready for wall pour.

